



BI-WEEKLY UPDATE

Hats Off

We would like to acknowledge two OC researchers, Melissa Munn, and Leonard Lerner for their commitment to ensuring students are engaged in applied research projects.

Cool Tool Alert: Filter Codes in Moodle

Would you like to welcome students by name into your course shell? Filter codes in Moodle allow you to do this, and more. All you need to do is follow these short steps:

1. Select the cog in the right corner of your course page and then select "Filters"
2. Find "Filter Codes" and set it to "On"
3. Determine where you would like to place the text
4. Type in this format into the textbox:
 - i. Welcome {firstname} to {coursename}

And presto! A personalized welcome to your specific course will appear. Stay tuned for more filter applications.

Points of Note:

Applied Research Strategy Town Halls

Hold the dates

The Inspire Applied Research Strategy project team wants your ideas about the future of applied research at Okanagan College and will be holding virtual town hall meetings at the following times:

- Tuesday, October 18, 10:30 a.m. to 11:30 a.m.
- Wednesday, October 19, 1:00 p.m. to 2:00 p.m. or 2:00 p.m. to 3:00 p.m.
- Friday, October 21, 1:00-2:00 p.m.
- Monday, October 24, 8:30 a.m. to 9:30 a.m.

The town halls will provide background information on the state of applied research at OC today and will offer you the opportunity to help shape the strategy that will guide us in the future. Two or three members of the project team will be in attendance at each town hall session to lead the conversation and answer your questions.



LEARNING & APPLIED RESEARCH

connecting for learning and innovation

If you would like to attend, please email learningandappliedresearch@okanagan.bc.ca with the date and time of the town hall that you will be attending. A Zoom link for the session will be sent to you. If you are unable to attend any of the sessions but would like to provide input, please send an email to learningandappliedresearch@okanagan.bc.ca.

Thank you from the project team members:

- Beverlie Dietze, Director, Learning and Applied Research
- Bill Gillett, Dean, Okanagan School of Business
- Carly Hall, Dean, Health and Social Development
- Judith Anderson, Dean, Arts and Foundational Programs
- Richard Federley, Interim Dean, Science and Technology
- Ross Tyner, Director, Library Services
- Sonja Lloyd, Lab Technician, BC Beverage Technology Access Centre
- Stephen Speers, Dean, Trades and Apprenticeship

Online Webinars - TAC Talks

Online Webinar
Join us to hear Dre Pao explain how the Canadian Beverage Industry can use and adapt their marketing initiatives using TikTok.

BCBTAC
BREWED · FERMENTED · DISTILLED

NSERC CRSNG

okanagan college

TAC Talks with Dre Pao a TikTok Master

THURSDAY
OCTOBER 20, 2022
4:00 - 5:30 PM PST

Speaker
Dre Pao
Content Creator and Digital Strategist

Dre Pao is best known for his TikTok snack content. Dre has built a following of over 200K food lovers and created content for major snack brands. As the founder of Xrozs Group, he has built a full-service vertical media agency that specializes in creating and managing TikTok profiles for some of the top CPG food brands in Canada and the USA.

REGISTER NOW

PRESENTED BY BCBTAC
BC BEVERAGE
TECHNOLOGY ACCESS CENTRE
#BCBTACTalks



LEARNING & APPLIED RESEARCH

connecting for learning and innovation

Coming Soon...

Research Data Management

Good data management is beneficial to researchers, research communities, and society in general. In the digital research environment, it is also increasingly becoming an expectation and requirement. Through an open letter to all post-secondary institutions, the Tri-council announced the launch of the Tri-Agency Research Data Management Policy. The agencies will take a phased, incremental approach to policy implementation, the first requirement being the development of an institutional RDM strategy. Stay tuned for calls for engagement and development of Okanagan College's Research DATA Management Strategy.

Mobilize Grants

Please stay connected for information on opportunities to apply for applied research funding.

did you know?

SINCE THE START OF THE FALL 2022 TERM...

9,439 unique users
haved logged in Okanagan College Moodle
a total of 330,903 times

The Moodle logo, which consists of a black graduation cap above a stylized orange letter 'm'.

New Moodle Help Options

There are new options for Moodle Help located on any Moodle page from the top dropdown menu. Why not check them out? There is a Moodle Student Tour that you may find extremely useful. It demonstrates how to edit your profile, manage your dashboard, and how students submit assignments and contribute to forums. Please recommend this tour to students new to Moodle.



LEARNING & APPLIED RESEARCH

connecting for learning and innovation

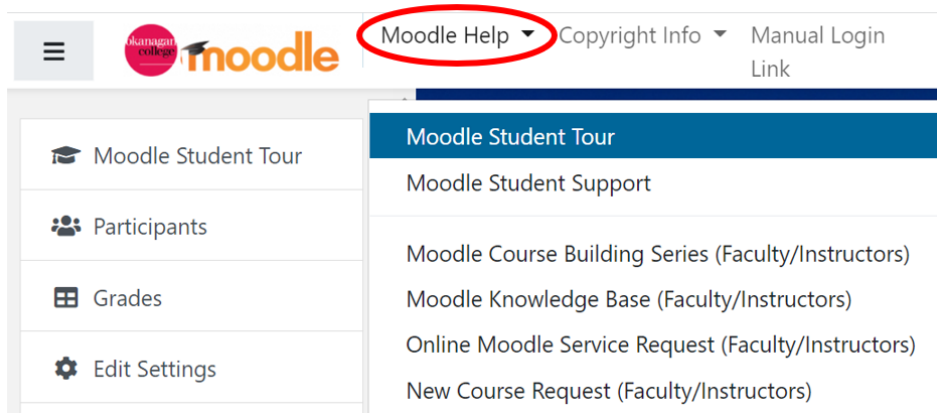

Learn about other Moodle Help options in upcoming Bi-Weekly Newsletters!

When something goes wrong with your Kaltura Virtual Classroom

In order for Kaltura to investigate recording or other issues, an incident ticket must be created from within the live session where the issue occurred. For detailed instructions on how to submit an incident, please follow this [link to the Kaltura Knowledge Center](#).

For support with

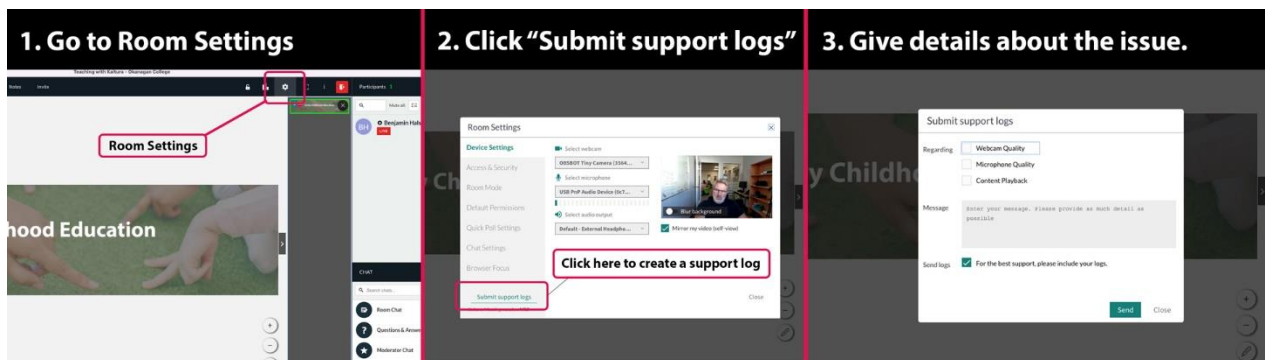



5 THINGS TO KNOW ABOUT ALL THINGS RESPONDUS

Making sense of the different Respondus Tools available to you.



RESPONDUS 4.0 FOR BUILDING

Respondus 4.0 is a powerful software application for creating and managing exams (and question banks) that can be published directly to your Moodle courses.

It is especially effective in converting existing question banks to Moodle format and allows you to create your assessments offline for upload at a later time.



...AND FOR RETRIEVAL

As good as Respondus 4.0 is at creating exams, it's equally effective at extracting existing exams and question banks from your Moodle courses. This is a great method to generate paper copies of your quizzes and exams, which may be helpful for accessibility-related accommodations. Extracted quizzes and question banks can also be quickly updated and then shared between other Moodle courses.



LOCKDOWN BROWSER FOR DELIVERY

Respondus LockDown Browser is a custom browser that locks down the testing environment within Moodle. When students use Respondus LockDown Browser they are unable to print, copy, go to another URL, or access other applications. The browser is available for Windows and Macintosh computers, as well as iPads.



RESPONDUS MONITOR FOR PROCTORING

Respondus Monitor is a fully automated proctoring solution that makes use of the student's webcam and microphone to record them while completing an online exam. The application then analyzes the exam session using advanced artificial intelligence to generate a report that ranks results by risk, helping instructors identify which sessions may warrant deeper scrutiny.



WORKING TOGETHER, OR NOT

LockDown Browser can be used on its own, but Monitor cannot - it requires that LockDown Browser first be enabled for the assessment. It's important to note that LockDown Browser will not allow the use of other potential virtual proctoring tools, such as Zoom, as that is precisely the type of application that LockDown Browser is designed to lock down. And additionally, if your exam requires the use of another application such as Word or Excel, you will not be able to use LockDown Browser or Monitor.

<https://www.okanagan.bc.ca/lar>



Turnitin

Did you know that not only is Turnitin 2.0 a Moodle Activity for checking assignment similarity, it is also a plug-in for Moodle Assignments and even Moodle Workshops and Forums?

Directions: Create an Assignment in Moodle, toggle open Turnitin plagiarism plugin settings and enable. You can adjust the settings as you would in Turnitin 2.0. Turnitin Quickmark, Peermark, and Rubrics can be applied. The advantage is that Moodle Feedback Comments will appear in the Moodle Gradebook and you can provide directions to students regarding how to access the graded paper. This is especially important for students using this process for the first time.

▼ Turnitin plagiarism plugin settings

- Refresh Submissions
- Launch Quickmark Manager
- Launch Peermark Manager

Enable Turnitin	Yes
Display Similarity Reports to Students	Yes
When should the file be submitted to Turnitin?	Submit file when first uploaded
Allow submission of any file type?	No
Store Student Papers	Standard Repository

Learning and Teaching with LAR: Alternative Assessments

This series will be providing options for alternative assessment in each upcoming bi-weekly. Please let us know if you would like one of your approaches shared by emailing learningandappliedresearch@okanagan.bc.ca

1. Annotated Portfolio

Description:

- As students complete low stakes, formative assessments throughout the course, they are provided with feedback from their instructor, professor or classmates. They then modify their work based on this input. At the end of the term, students submit these revisions and a reflection on their approach to completing the assignments, the feedback they received, and their key learning.

Benefits:

- Provides scaffolded practice with concepts throughout the term.
- Fosters metacognition by having students reflect on their learning.



LEARNING & APPLIED RESEARCH

connecting for learning and innovation

- Provides students with a tangible sample of their work and growth throughout the term that can then be used to contribute to a broader portfolio.

When this might be useful:

- For large projects / assignments that benefit from being parsed into smaller sections.
- For developing core competencies requiring consistent practice and reflection.

2. Four Corners

Description:

- On chart paper, put up a different topic in each corner of the room and ask students to pick one, write their ideas about it, then head to “their” corner and discuss opinions with others who also chose this topic. For online delivery, individual breakout rooms could be created and a PDF or PowerPoint shared with the topic or problem in each room. If desired, groups can then post or share their findings with the rest of the class.

Benefits:

- Provides opportunities for students to puzzle independently with a topic or problem and then share and receive feedback from other learners collaboratively.
- Provides choice, allowing learners to select the topic they are most interested in, while benefitting from the insights of the other groups when they visit their corners.

When this might be useful:

- To provide opportunities for solving complex problems, examining unique cases or discussing critical topics.
- For multifaceted course topics / issues.
- To heighten learner engagement when the class energy is low.

Upcoming Workshops:

• The 10 Step Process to Curriculum Design	Oct. 18	9-10 am
• Gradebooks in Moodle	Oct. 27	9-10 am
• Introducing MOM, the My Okanagan Math Assessment System Leveraging IMathAS	Nov. 7	11-12 pm
• Program Mapping- What does it mean and why have one	Nov. 14	2-3 pm

And more! Visit our entire schedule and register [here](#)



LEARNING & APPLIED RESEARCH

connecting for learning and innovation

BCcampus:

Oct. 17- Nov. 18 **BCcampus Universal Design for Learning (UDL) Explorer Series** [Register Here](#)

Interesting Podcasts

Please check out our new podcast section of the Bi-weekly. The podcast is called “Our Teaching Practice” and explores the experiences of Okanagan College instructors and faculty associated with their day-to-day teaching practice. Visit [Our Teaching Practice](#) to listen in.

Team Dynamics Service Requests

Your Moodle import has gone awry, and you need support asap. If this is the case, the best way to contact the entire Ed Tech Team is through a Team Dynamics service request. You can submit this by using the edtech@okanagan.bc.ca email address, rather than the personal emails of the education technology coordinators. This approach creates a record of your request and gets all available eyes on it immediately.

Our LAR team is here to help you with your instructional questions using Moodle and innovative ways to teach online, and we look forward to working with you to show you how to get the most out of the experience. Reaching us by email at [LAR](#) is the **very best** way to connect with us. We aim to respond as soon as we are able so that we can support you in finding good solutions to your questions. Please ensure you include the detailed course name and as much information as you can when making an inquiry.



Visit us on [Instagram!](#)